

Live Storage - *the* solution for storage and picking



Ergonomic access to the maximum number of products



Shorter distances mean savings in time and money and greater picking efficiency - and you save space too!

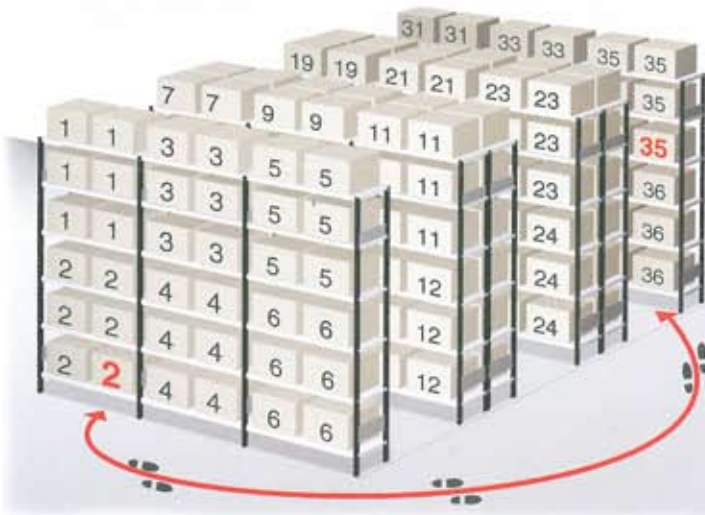

Dynamic storage means fast, easy flow-through and the highest possible storage capacity at the same time - the ideal combination of storage and accessibility.

40%

Where storage and picking is at the same location, SELECTAFLO offers the ideal solution: compact, First-in/First-Out (FIFO) efficiency and dynamic flow-through control, combined with maximum product storage in the smallest possible space and the most ergonomic picking method. SELECTAFLO is acknowledged as the perfect solution for manual picking of large volumes.



SELECTAFLO: a single system to facilitate the picking of whole cartons as well as single parts.

Advantages that speak for themselves

SELECTAFLO dynamic storage offers a range of advantages, including time and space savings, substantial reductions in picking errors and a host of other competitive enhancements:

- Safe management of time-sensitive "best-before" products
- Separate stocking and picking
- Simultaneous access to the maximum number of products
- Simple installation (no need for screws)

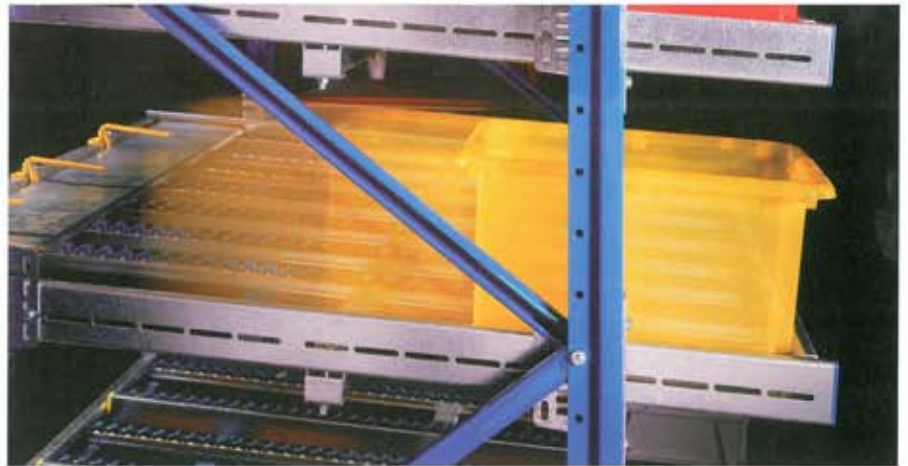

SELECTAFLO brings the goods to the picker, helping you to move products faster, easier, better.



- Simple shelf height adjustment
- Quality-proven components
- Track widths adjustable in 11.5 mm increments.
- Wide range of accessories including separators and picking systems
- Simple installation and integration with stationary pallet racks
- Can be integrated with automatic stocking systems



Separate areas for loading and picking ensure problem-free operation and minimum interruptions.

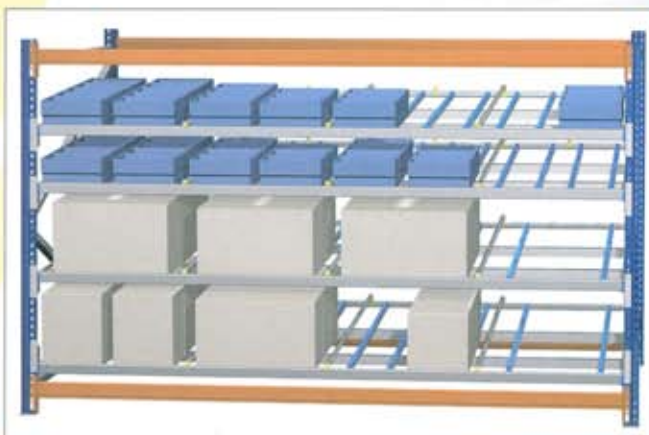

System flexibility means different track widths are available to accommodate a range of existing shelf widths.

A flexible system - can be optimised for all requirements

The versatile and flexible SELECTAFLO modular system means your logistical needs are catered for perfectly, in the safest and most cost-effective way. Stationary rack systems such as DEXION P90 are easily integrated to create a complete high quality, high performance system. Our experienced specialists are available at all stages to assist you selecting the best combination of components for your needs.

SELECTAFLO's modular construction is the basis of its versatility

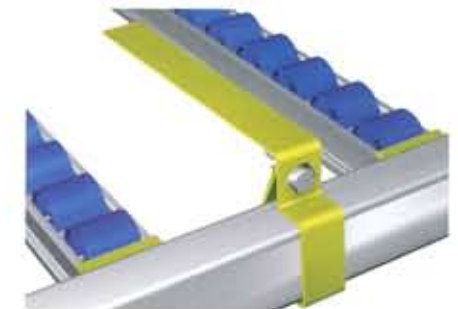
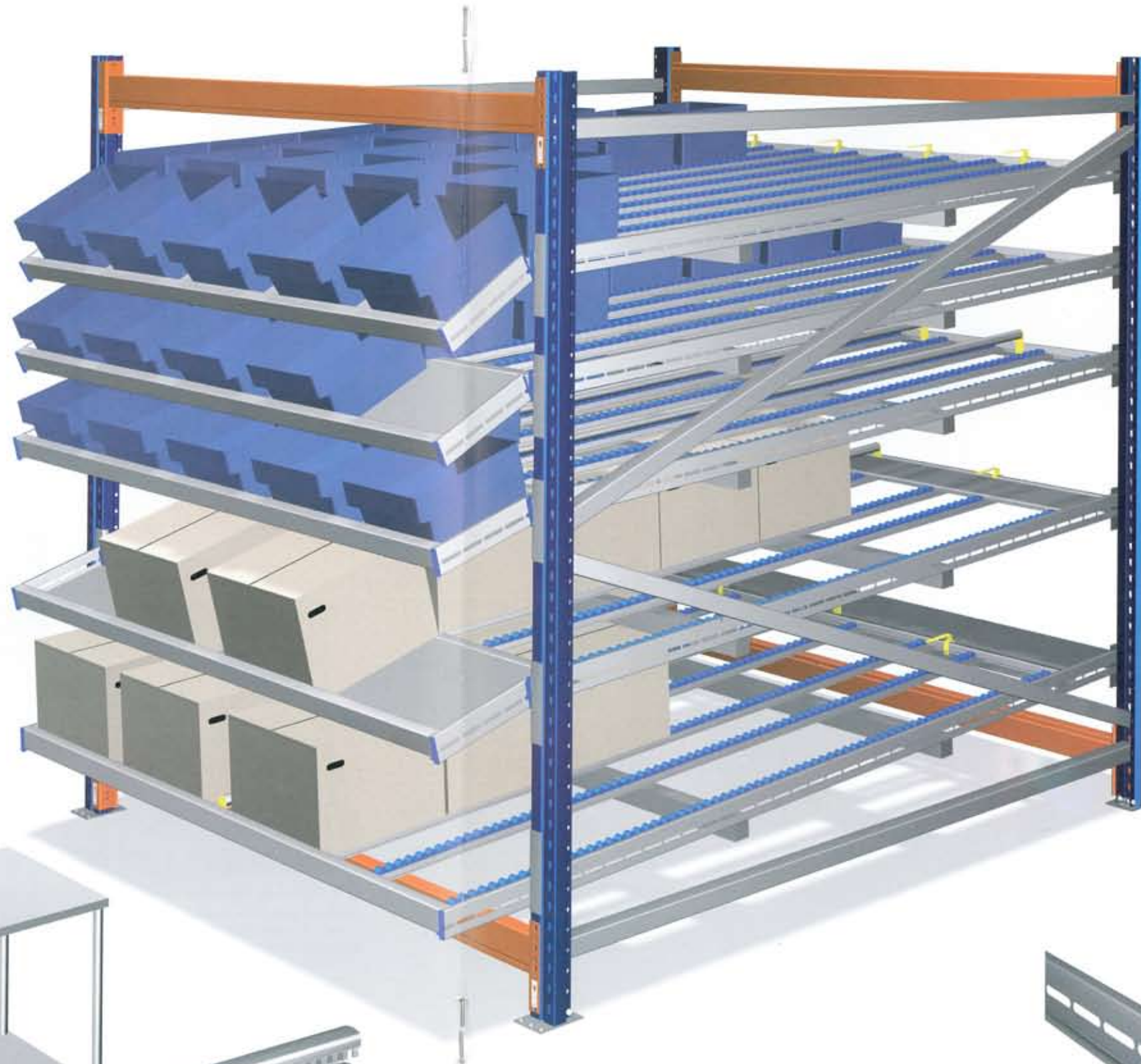

Entrance guides make loading a simple matter.

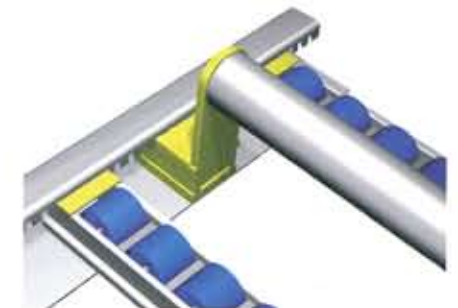

A full length divider keeps all goods in line and avoids carton damage.



Efficient loading and picking made simple with a loading plate and drop-out tray.



SELECTAFLO means simple and fast installation - and adjustment too.



Available in standard blue or a range of alternative colours.



Tracks are easily adjustable to accommodate all sizes of boxes or bins.

Customised solutions mean even greater productivity

Simple construction and flexible design means the versatile SELECTAFLO system is available in a number of combinations and configurations - from a simple stand-alone system for fast picking, to an integral part of a sophisticated automated warehouse management system for computer-controlled throughput.

This installation accommodates almost 115,000 boxes on 4 levels.



SELECTAFLO can be built in to active picking positions, with storage space above used as reserve.

The picking box is easily moved by a conveyor in front of the SELECTAFLO unit.

SELECTAFLO DYNAMIC



An automated feeder makes for simple loading of the SELECTAFLO system.



The SELECTAFLO solution, above, is fully integrated to the warehouse management system and will effortlessly handle up to 20,000 loads a day.

A special drop-out tray means more ergonomic picking from cartons.

Think outside the box

For further information on efficient small parts handling solutions, please contact your nearest DEXION specialists. From standard shelving to industrial paternosters, tower-systems and horizontal carousels, they will find the best solution to meet your needs.



In addition to SELECTAFLO, DEXION offers many other space-saving storage solutions. DEEPSTOR P90 drive-in racking can make your storage space up to 90% more efficient when compared to standard pallet racking.



DEXION materials handling solutions increase your productivity and can be designed according to your exact logistical needs - all from one of the world's largest product ranges which includes cranes, conveyors, storage systems, software and warehouse management systems.



The DEXION GROUP is a global leader for complete solutions in the storage, archiving and materials handling sectors.

The office filing system



Partitioning concepts

Compact Storage



Material handling systems

Control of logistic processes



Archiving!
Newly defined!

Constructor Sverige AB

Box 55043

S-400 53 Göteborg

Phone. +46 31 771 96 00

www.constructor.se